



MODULAR HOUSES 1.1 (14.4 m²) - £12,400

TECHNICAL DETAILS

- **METAL PARTS:** Material: ST 37
- **CEMENT BOARD:** Standard: TSE 634-2
- **EARTHQUAKE RESISTANCE:** Rating: Grade I
- **CLIMATIC CONDITIONS:** Classification: Third Climatic Zone
- **SNOW LOAD:** Capacity: 80 Kg/m²
- **POLYSTYRENE FOAM (EPS):** Standard: TS 7316
- **EXTERNAL WALL TRANSMISSION COEFFICIENT:** Value: 0.74 Kcal/m²hc
- **ROOF TRANSMISSION COEFFICIENT:** Value: 0.69 Kcal/m²hc
- **THERMAL TRANSFER COEFFICIENT OF THE FLOOR:** Value: 0.68 Kcal/m²hc
- **CHASSIS LOAD CAPACITY:** Capacity: 200 Kg/m²

FLOOR

- **METAL FRAME COATING:** Material: Fiber Cement Boards
- **FLOOR COVERING:** Material: PVC Vinilin

ROOF

- **ROOFING SYSTEM:** Type: Special seam clamps for sandwich panels made of PUR. Rainwater drainage through a special fastening system.
- **ROOF INSULATION:** Type: Special sandwich panel for roofs, complete thermal insulation. Rainwater is evacuated through hidden gutters in the roof structure.
- **EXTERNAL SURFACE COVERING:** Color: Ral 9002
- **INTERNAL SURFACE COVERING:** Color: Ral 9002

WALLS

- **SYSTEM:** Type: Special sandwich panel with PUR insulation
- **EXTERNAL SURFACE COVERING:** Material: Ral 9002 profile, metal sheet
- **INTERNAL SURFACE COVERING:** Material: Ral 9002 profile, metal sheet
- **WALL INSULATION:** Type: Special thermally insulated sandwich wall panel covered with galvanized sheet



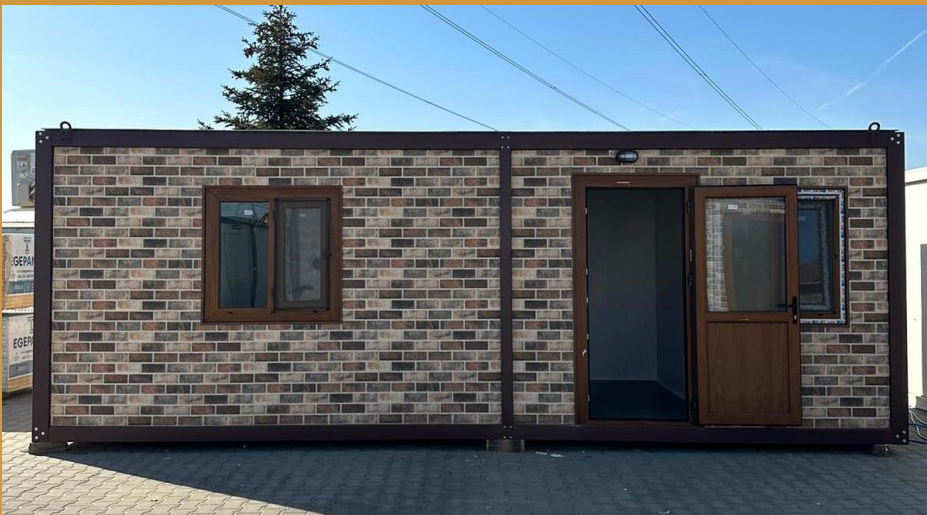





WHAT IS INCLUDED

- **Room and Bathroom Layout**
- **Bathroom equipped with sink + vanity unit + mirror, toilet bowl, electric tap, shower cabin**
- **Golden Oak UPVC Exterior Door, dimensions 900x2000 mm**
- **Golden Oak UPVC Room and Bathroom Doors, dimensions 800x2000 mm**
- **2pcs Golden Oak UPVC windows, dimensions 1000x1000 mm, fixed + tilt-and-turn**
- **1 bathroom ventilation window, 500x500 mm**

- **Air conditioning 12000 BTU with inverter**
- **Electric convector heater 1500 W**
- **Interior wall cladding with PVC paneling**
- **Exterior cladding with decorative polystyrene, pattern 001**
- **Finishes for doors and windows**
- **Electrical installation**
- **Plumbing installation**

1. **Project planning:** The customer works with Home Intelligent to create a custom project that meets their needs and budget. This includes the layout of the interior and exterior, as well as the type of finishes.

2. **Budget and contract:** Home Intelligent provides the customer with a detailed budget for the project and a contract that outlines the scope of work and the terms of the agreement.

3. **Production:** The modular home is built in a factory according to the approved project plan.

4. **Foundation and connections:** The foundation is prepared and the necessary connections are made to the utilities.

5. **Delivery:** The modular home is delivered to the customer's site and installed.

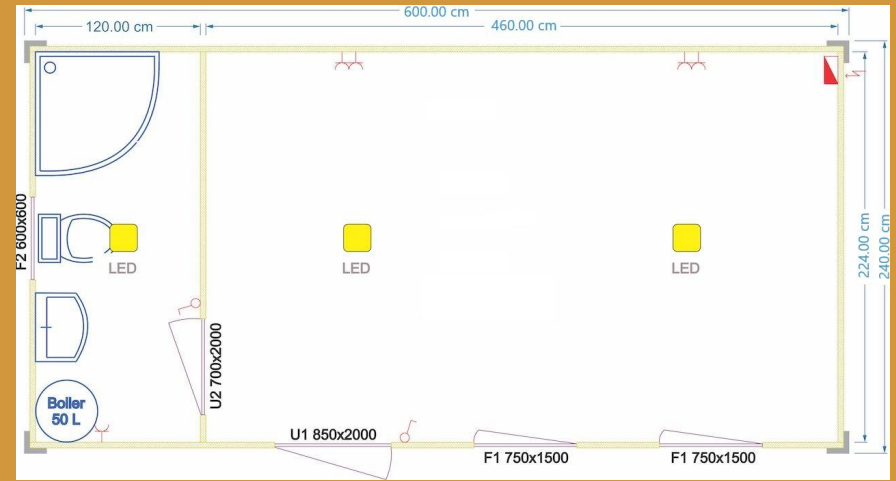

WEBSITE: www.home-intelligent.co.uk

EMAIL: contact@home-intelligent.co.uk

PHONE NUMBER: [+44 7751 954 142](tel:+447751954142)

ADDRESS: 37A, Palace Grove, BR13HB, LONDON, UK